

1. Place Pallet Caddy on pallet truck with front lip of caddy sitting in front of the pallet truck carriage and square caddy to pallet truck.
2. With marker, mark on the bottom side of the caddy the two drill points. Place the J-bolts as far toward the forks as possible for better stability.
3. Remove the caddy and using a 1/4" drill bit, drill the two holes marked in step two.
4. Set the caddy back in place and insert the j-hooks.

REVISIONS				
ZONE	REV.	DESCRIPTION	DATE	APPROVED

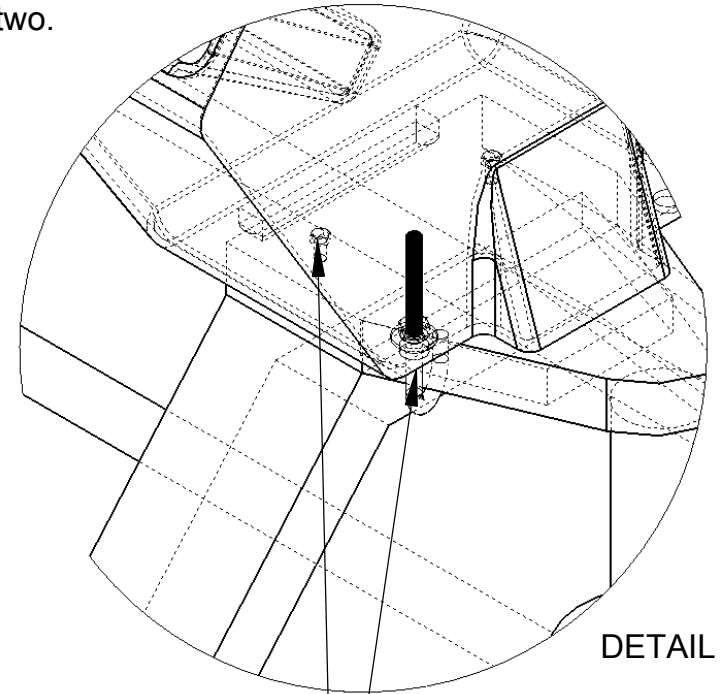
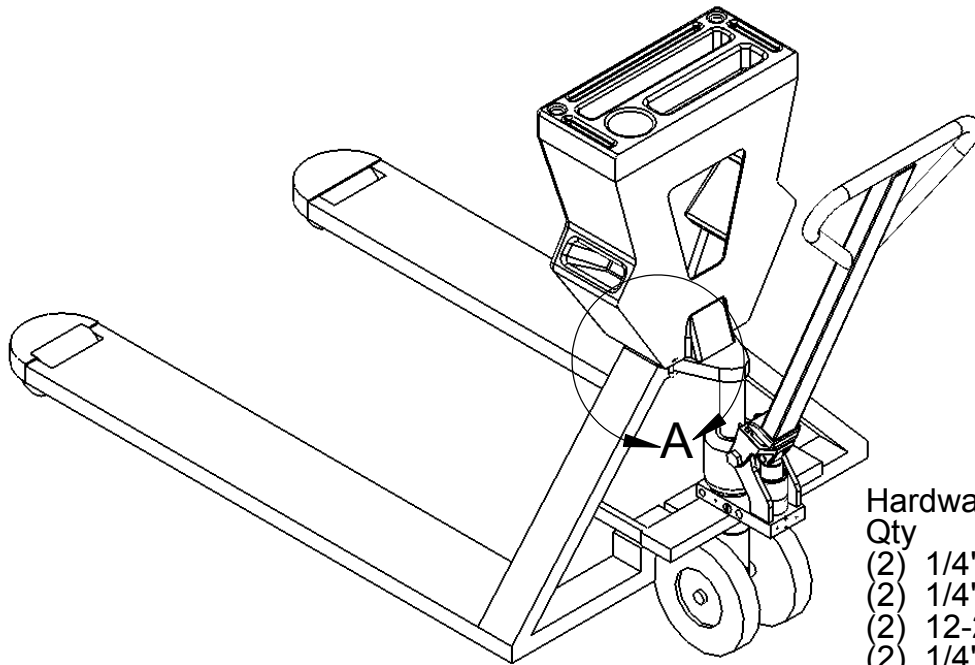

Hardware List

- Qty
- (2) 1/4" x 4" J-Bolt
 - (2) 1/4" Lock nuts
 - (2) 12-24 x 7/8" Self Tapping Screws
 - (2) 1/4" Flat Washer
 - (2) 1/4" x 1 1/4" Fender Washer

5. Install the washers over the threaded portion of the J-hook on the inside of the caddy and install the nuts. Tighten until snug. Make sure unit is level to pallet jack when done.
6. Add self drilling screws(included) as necessary taking care not to damage parts on the pallet jack

PROPRIETARY AND CONFIDENTIAL
 THE INFORMATION CONTAINED IN THIS DRAWING IS THE SOLE PROPERTY OF VESTIL MANUFACTURING CO. ANY REPRODUCTION IN PART OR AS A WHOLE WITHOUT THE WRITTEN PERMISSION OF VESTIL MANUFACTURING CO. IS PROHIBITED.

UNLESS OTHERWISE SPECIFIED: REMOVE ALL BURRS AND SHARP EDGES		
DIMENSIONS ARE IN INCHES		
CONCENTRIC	.006 TIR	.060 TIR
ANGLES	± 0° 30'	± 1° 0'
	x.xxx ± .005	
	x.xx ± .010	
DECIMALS	x.x ± .025	± .015
FRACTIONS	± 1/32	± 1/16
TOLERANCES	MACHINE	WELDMENT
COMMENTS:		
DO NOT SCALE DRAWING		

Vestil Manufacturing Co.			
DESCRIPTION: CADDY INSTALLATION			
DRAWN BY: JY	DATE: 02/02/05	SCALE	SIZE
CHECKED BY: MC	DATE: 02/02/05	SHEET 1 OF 1	A
MATERIAL	DWG. NO.	020205A	REV